

# Astroworx EQ6 pier adapter plate: installation instructions

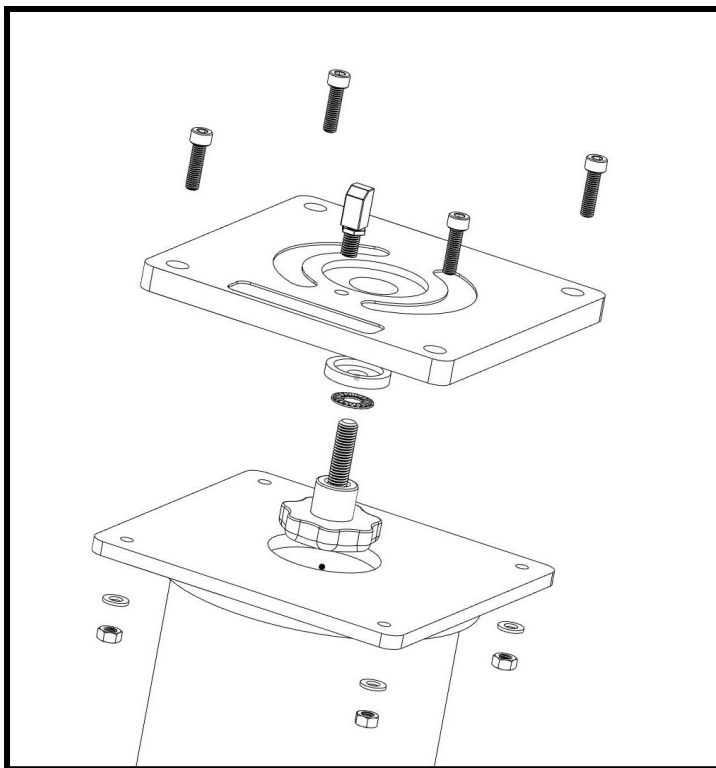

Thank you for purchasing the Astroworx EQ6 pier adapter plate. This plate was designed and made in Australia to high quality specifications.

This pier adapter plate is intended for NEQ6, EQ6-R and AZ-EQ6 mounts and similar. It is not intended for smaller mounts (such as HEQ5) or larger mounts (such as EQ8).

The pier adapter plate is also intended for either the Astroworx or iOptron permanent pier.

## Package contents:

- Pier plate
- Azimuth adjustment post and locking nut
- Centre locking bolt
- Flat bearing
- Spacer
- 4 x M8 plate attachment bolts, washer, nut

## Installation instructions

### Step 1: Install the azimuth adjustment post

Leave the locking nut screwed onto the azimuth adjustment post. Screw the azimuth adjustment post into the M10 hole provided until it is fully inserted. Next, unscrew the post until the chamfer faces the outside of the plate (as in the diagram). Using a spanner to hold the post in this orientation, lock the post in position by tightening the locking nut against the pier adapter plate.

### Step 2: Attach the pier adapter plate to the EQ6 mount

Place the flat bearing onto the centre locking bolt. Next, place the spacer on the centre locking bolt so that the flat bearing contacts the flat part of the spacer (as in the diagram). Place the pier adapter plate on the bottom of the mount with the azimuth adjustment post between the azimuth adjustment bolts on the mount. Thread the centre locking bolt through the bottom of the pier adapter plate into the M12 hole in the mount. Fully tighten the mount attachment bolt. The flat bearing and the Delrin inserts allow the mount to rotate in azimuth during polar alignment.

### Step 3: Bolt the pier adapter plate and mount to the pier top.

Position the adapter plate and attached mount on the top of the pier (not included) so that the counterweight is on the south of the pier in the Southern Hemisphere (or north of the pier in the Northern Hemisphere). Bolt the adapter plate to the pier using the four M8 cap head bolts. The bolt is inserted at the top, with a washer and nut threaded on from below. The centre locking bolt will fit through the large hole in the pier top.

Astroworx is a brand of Sidereal Trading Pty Ltd  
© Sidereal Trading Pty Ltd

**ASTROWORX**